

2.6. Manuals

Manual 402-40 is available upon request and can be used as a guide in soldering. This manual provides information on various flux types and characteristics along with the commercial designation and flux removal procedures. A checklist is included in the manual as a guide for information on soldering problems.

3. REQUIREMENTS

3.1. Mounting Holes and Panel Cutouts

Dimensions and layout for mounting holes and panel cutouts are shown in Figure 2.

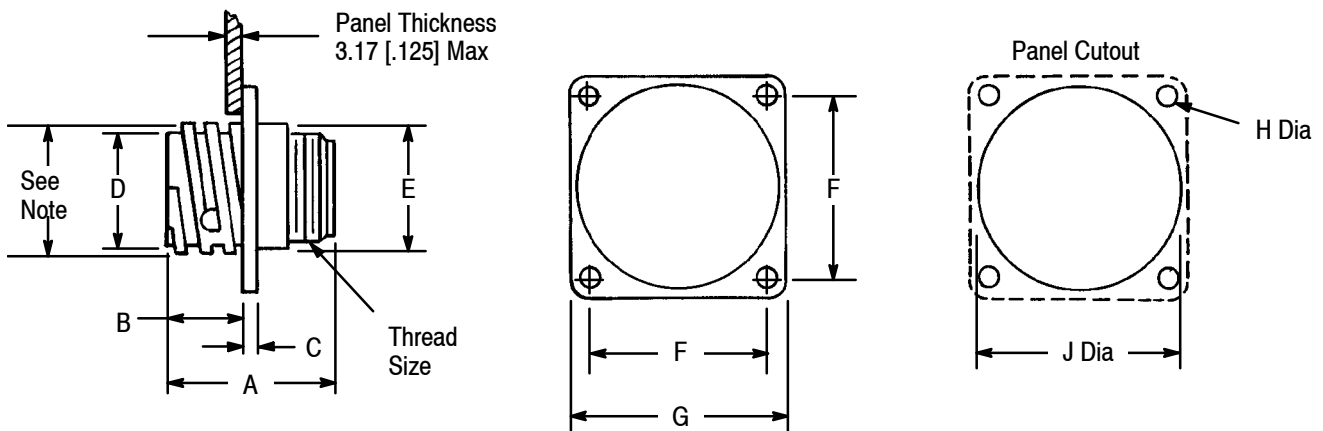

SERIES	ARRANGEMENT NUMBER	SEX	A MAX	B $\pm 0.38$ [.015]	C $\pm 0.25$ [.010]	D $\pm 0.25$ [.010]	E MAX	F $\pm 0.25$ [.010]	G $\pm 0.64$ [.025]	H $\pm 0.18/0$ [+0.007/0]	J	THREAD SIZE
Series 1	11-4	Rev	27.18 [1.070]	10.67 [.420]	2.39 [.094]	17.45 [.687]	18.80 [.740]	21.44 [.844]	28.58 [1.125]	3.18 [.125]	21.34 [.840]	5/8-24 UNEF-2A
		Std	34.29 [1.350]									
	13-9	Std	34.29 [1.350]	10.67 [.420]	2.39 [.094]	20.62 [.812]	22.33 [.879]	24.61 [.969]	32.54 [1.281]	3.18 [.125]	24.87 [.979]	3/4-20 UNEF-2A
	17-14	Rev	27.18 [1.070]	10.67 [.420]	2.39 [.094]	26.67 [1.050]	28.19 [1.110]	28.58 [1.125]	36.45 [1.435]	3.81 [.150]	30.73 [1.210]	15/16-20 UNEF-2A
	17-16	Std	34.29 [1.350]									
	23-24	Std	34.29 [1.350]	13.21 [.520]	3.96 [.156]	36.53 [1.438]	38.35 [1.510]	36.53 [1.438]	44.45 [1.750]	3.81 [.150]	40.89 [1.610]	1-3/8-18 UNEF-2A
23-37	Rev	27.18 [1.070]	13.21 [.520]	3.96 [.156]	36.53 [1.438]	38.35 [1.510]	36.53 [1.438]	44.45 [1.750]	3.81 [.150]	40.89 [1.610]	1-3/8-18 UNEF-2A	
	Std	34.29 [1.350]										
Series 2	11-8	Std	20.55 [.809]	10.67 [.420]	2.39 [.094]	17.48 [.688]	16.00 [.630]	21.44 [.844]	28.58 [1.125]	3.18 [.125]	21.34 [.840]	5/8-24 UNEF-2A
		Rev										
	11-9	Std										
	17-28	Std	20.55 [.809]	10.67 [.420]	2.39 [.094]	26.67 [1.050]	23.95 [.943]	28.58 [1.125]	36.45 [1.435]	3.81 [.150]	30.73 [1.210]	15/16-20 UNEF-2A
		Rev										
	23-57	Rev	23.47 [.924]	10.67 [.420]	3.96 [.156]	36.53 [1.438]	38.48 [1.515]	36.53 [1.438]	44.45 [1.750]	3.81 [.150]	40.89 [1.610]	1-3/8-18 UNEF-2A
23-63	Std											

Figure 2 (cont'd)